



MEDCRUISE NEWS

QUARTERLY SEPTEMBER 2007

ISSUE 17

Seatrade Med 2008

Venice to host next Seatrade Med 2008

MedCruise member Venice is hosting the next Seatrade Mediterranean Cruise & Ferry Convention which will take place at The Venice Passenger Terminal, from 9-11th December, 2008.

Seatrade Med 2008 will feature major conference sessions on the dominance of the cruise industry in the Mediterranean, combined with the outlook for the ferry industry in these competitive waters.

Sandro Trevisanato, President of the Venezia Terminal Passeggeri S.p.A. commented, 'we are proud to host Seatrade Med in Venice', adding 'this confirms Venice and the Veneto Region as one of the undisputed leading players in the global maritime sector.' Laurent Monsaingeon, president of MedCruise stated, 'MedCruise congratulates our member port Venice for having been selected to host the next edition of Seatrade Med. We are delighted that the event will be held on the grounds of Venice's Passenger Terminal, which is a state-of-the-art facility we are certain will please visitors and exhibitors alike.'

As a supporting organisation MedCruise will be



participating as an exhibitor and is planning its biggest ever MedCruise pavilion.

Venice has seen a rapid increase in cruise traffic over the past years and in 2007 is expecting to receive more than 980,000 passengers on over 440 cruise calls, representing a 4.4% increase in calls compared to last year and an 11% rise in passengers.

In response to the continued growth in cruise passenger traffic at the Adriatic port, new facilities were inaugurated late last year – a new 4,300sq mtr Terminal 117, the port's fourth dedicated cruise ship facility.

Meanwhile work on a fifth terminal is already underway involving the conversion of a large warehouse with a surface area of 13,000sq mtr located on Isonzo quay. It will be finished by the end of 2008. Built on two levels, it will provide two 7mtr gangways and be used mainly for home porting operations.

'Since 1997 when VTP was founded we have worked quickly to convert existing warehouses into multipurpose facilities which can also be

utilised for hosting meetings and conventions when not in cruise use,' says Roberto Perocchio, managing director of Venice Passenger Terminal. Other work recently carried out includes the resurfacing of the car parking facilities and a project of an additional parking area resulting in 2,500 more spaces available for port use and for the city.

The growth in volume of cruise passenger traffic at Venice also has important economic implications for the city. Recent research conducted by Venice University's IDEAS Centre, in collaboration with Risposte Turismo srl, revealed the total estimated value of direct spending by cruise passengers, 60% of whom spend at least one night in Venice on pre- or post-cruise stays, reached €148m in 2005.

Venice's singular appearance, its countless attractions and wealth of art treasures make it unique. Anyone participating in Seatrade Med 2008 should take the opportunity either pre- or post- show to experience its many attractions.



Venezia Terminal Passeggeri - venue for Seatrade Med

MedCruise General Assembly Almeria 18th-19th October 2007

On 18-19th October 2007, the MedCruise General Assembly will take place in Almeria.

Over 60 professionals from more than 40 different ports will come together with cruise line executives and members of the international cruise media to discuss latest trends and issues and the Western Med Itinerary Conference, amongst other agenda items.

In 2007 Almeria will receive 56 cruise calls bringing more than 35,000 passengers.

Cruise passengers calling at the Port of Almeria can take a variety of shorex including the ancient Muslim Alcazaba Castle, Cabo de Gata Natural Park and the charming little white village of Mojacar.



Almeria Port - welcomes delegates

Barcelona

Preparing to turnaround Genesis class

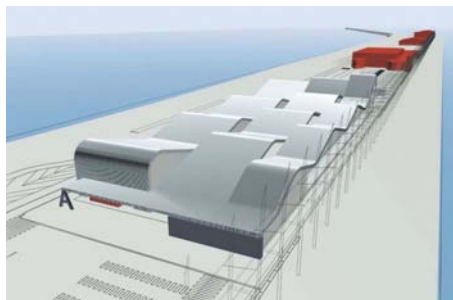

Barcelona Port is continuously improving its cruise facilities to keep pace with the accelerated growth of passengers brought by larger capacity ships entering the market.

There are six permanent turnaround terminals available at the port, with a total berthing capacity of over 2,500mtr. The private company Creuers del Port de Barcelona operates five of the terminals as public facilities open to all cruise companies, while Terminal D, Palacruceros, has been wholly financed by Costa Crociere Sp.A. and offers preferential berthing for Carnival Corp. ships.

Creuers del Port de Barcelona is currently building and financing the brand new Terminal A (pictured above), designed with the most modern requirements for mega ships carrying over 4,000 passengers, in terms of comfort, security, smooth and fast processing and luggage facilities. The Terminal will be ready by mid April 2008, in time for the new cruise season.

A 400mtr gangway will link Terminals A and B, enabling the handling of Genesis class ships under construction at Aker Yard, as half the passengers, some 3,000, will use Terminal A and the other half Terminal B.

Barcelona Port will receive nearly 800 cruise calls in 2007, compared to 714 ships in 2006.

The Port of Barcelona achieved another passenger record during the first half of the year. From January to June 2007, Barcelona received 618,680 cruise passengers, an increase of 33% compared with figures of year 2006. The forecast for the 12 months is an increase of about 15%, reaching 1.6m passengers thereby keep its lead position in Europe.

Gibraltar

Plans to expand alongside berthing



At present, Gibraltar Port is capable of berthing alongside all ships that call, except for Queen Mary 2 which tenders. The Government is currently studying plans that will allow the larger ships under construction to berth alongside. There are also plans to expand the cruise terminal for the benefit of the greater number of passengers that will be travelling on the larger ships.

In March Capt. Cliff Brand took on the role of Chief Executive /Captain of the Port for Gibraltar. He started his seagoing career as a fisherman before joining the Merchant Navy, initially as an officer of the watch and progressing to master.

After a 12-year Merchant Navy career and a further period ashore in management, Brand joined the UK's Marine Accident Investigation Branch. During the eight years he spent at the MAIB he was responsible for investigating more than 60 serious accidents, many involving the loss of life.

In February 2005 he took up the post of Maritime Administrator for the government of Gibraltar, where he was head of the Gibraltar Maritime Administration, before taking up his current post.

Some 225 cruise calls are scheduled at Gibraltar in 2007. This is an increase over 2006 when 202 ships visited the Rock.

Koper

Eight maiden calls

Koper has witnessed an increase in cruise traffic in 2007. By the end of the season, 60 ships are expected to call. This is a huge 172% jump in traffic compared to last year when 22 ship visited. A total of 25,000 passengers will pass through the port this year and there are already 45 confirmed calls for 2008.

There has been maiden calls from eight cruise ships in 2007: Kristina Regina, Dalmacija, Veendam, Boudicca, Discovery, Spirit of Adventure, The Emerald and Arion.

The passenger port has been reconstructed with the addition of new facilities including a bus parking area, souvenir shops and market stalls selling local products at the quayside. Work on a new terminal is still ongoing and is due to be finished in 2008.



Lisbon

Centennial celebrations

A new record is expected to be reached in Lisbon this year. The Port is due to receive in excess of 300,000 passengers, more than a 10% increase on last year when 271,000 passengers passed through the port.

This year Navigator of the Seas called at Lisbon for the first time as well as AIDAdiva (pictured) and MSC Orchestra calling on their maiden voyages. When entering the Tagus estuary these ships were escorted by tugs equipped with cannons spreading water streams. As usual on first calls, the Port Authority offered the passengers and crew a welcome ceremony which included a musical performance and a small souvenir. More cruise ships will be coming to Lisbon for the first time later in the year, Norwegian Gem, Emerald Princess and Queen Victoria, and similar ceremonies are being prepared.

To mark the 100th anniversary of the Port of Lisbon Authority this year, a photography exhibition took place at the Rocha Conde de Obidos Cruise Terminal throughout the summer where visitors had the opportunity of seeing the Port Authority's magnificent photo heritage spanning the last 100 years.



Malaga

5,000 cruisers simultaneously

A total of 332 cruise calls are expected in 2007, an increase from 229 ships called at the port.

Construction of The Great Passenger Terminal, located at the Eastern Dock, is underway with the first phase completed this summer (pictured). The port will be able to receive more than 5,000 cruisers simultaneously, and a yearly total of 560,000 passengers. The new Terminal will make Malaga appealing as a homeport as modern technology for luggage handling and services are the key to its design. It will have two mooring points for ships over 300mtr and 17mtr depth. This will increase the Port of Malaga's mooring points to

eight. The total investment runs to €21.3m.

The Port of Malaga is located in the historical city centre, allowing visitors to reach many places very easily. The Alcazaba Arabic Fortress and Gibralfaro Castle lie at the top of the mountain offering beautiful views of the city. The Picasso Museum, the house where the artist was born, showcases some of his most important work. There are also several short trips available from the city centre. Ronda is an art lesson from prehistory to the present time, as is Antequera. Nerja with its amazing caves, exclusive Puerto Banus or the white village of Mijas are just a sample of the beauty of the area. A stone's throw away from Malaga are the cities of Granada, where the Alhambra



Palace can be visited, the Mosque in Cordoba or the Giralda tower in Seville. Also not far from the Costa del Sol's capital are Gibraltar and Morocco.

La Goulette

Two new berths to be constructed



Passenger numbers are growing at the Tunisian Port of La Goulette. Expectations for 2007 are good with 450 calls expected to bring 600,000 passengers. This compares with 416 calls and 575,515 passengers in 2006. Two ships made their maiden calls to Tunisia this season: MSC Musica and Costa Concordia.

At the beginning of 2007, Goulette Shipping Cruise took over the management and operation of the cruise business at the port of La Goulette with the objective to enhance performance and build on the services offered. To assist this process the company intends to build two berths of 640mtr in length and a traditional Tunisian-style tourist village of 6,500sq mtr in area.

Two small passenger terminals will be constructed alongside the two new berths which are planned to be operational during peak season 2009, according to Lotfi El Ajmi, training director of Tunisian Port Authority and MedCruise Board Member.

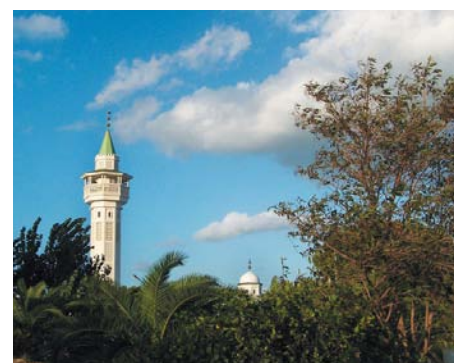

Ravenna



New terminal planned for 2010

There are 20 cruise calls planned for Ravenna in 2007, up from 17 in 2006. The Port's new Cruise Passenger Terminal at Porto Corsini is due to be completed in 2010.

Situated on the right hand side of the breakwater entrance, the new terminal will result in reduced berthing times and the possibility to host larger and longer vessels (as two of its four berths will be able to accommodate cruise ships of up to 300mtr in length and 10.5mtr draught). The adjacent area, measuring 14 hectares, is to be urbanised and will host a new maritime station, office space, ample parking spaces, residences, luxury hotels and parks.

The most popular shore excursion continues to be Ravenna's City Centre UNESCO monuments, eight of the city's early Christian and Byzantine religious buildings and their extraordinary mosaics dating back to the 5th and 6th Centuries.



Sevastopol

50% increase in traffic



Sevastopol's cruise calls has seen a 56% rise in the last year. In 2006, 30 ships called and in 2007, 47 ships will visit the Ukrainian Black Sea port in a season running from May to November.

The most popular shore excursions from Sevastopol are the Crimean War Tours including visits to the Panorama "Defence of Sevastopol 1854-1855" Museum and Balaklava Battlefield, Sevastopol City tours and the National Preserve, Chersonesus of Taurika. Closeby is the ancient Greek city of Chersonesus founded in 422 BC and Bakhchisaray, home to the ruling Khans in the 15th century.

Palamos

Tall Ships extravaganza



The Port of Palamos has seen a massive 72% increase in cruise calls over the past year. The Spanish port received 18 calls in 2006 and by end 2007 expects 31 for the year.

Building work has begun on a new terminal located in the commercial dock area which has recently been lengthened to 386mtr. Another dock is at the disposal of smaller cruise ships of under 150mtr in length.

In July, the Tall Ships Race 2007, which is held in the seas off the Spanish, French and Italian coasts, called at the Port of Palamos. At one point 17 ships were docked at the port which welcomed visitors onboard for a closer inspection. More than 25,000 people enjoyed the event.

Popular shore excursions include the Dali Museum in Figueres, the medieval villages of Pals and Peretallada, the PGA golf course at Catalunya and the Jewish quarter in Girona.

Split

Rise in cruise calls



In 2007, the Port of Split is expecting in excess of 200 calls up from 162 last year. At present the port is capable of handling ships up to 160mtr in length and 7.9mtr draught but work has begun on the lengthening of St Petar Pier at the City Port.

The Pier will be used to accommodate local and international traffic including cruise ships. Also, construction of summer berths is planned on the southern side of the breakwater.

Split is the second largest city in Croatia and the largest on the Adriatic Coast. The most popular excursion taken by passengers is the City Tour including a visit to the Diocletian's Palace, the Maritime Museum, the Museum of Archaeological Monuments and the Mistrovic Gallery, in the painter's summer residence which was finished in 1939.

Valletta

Winter cruising takes off

2007 has seen the start of year-round cruising for the Port of Valletta with ships visiting each month of the year. Expectations are high for the future. For 2007 Valletta will receive 384 cruise calls bringing an estimated 420,000 passengers.

Valletta is capable of handling the largest cruise ships sailing in the Mediterranean, yet cruise operations manager, VISET plc, is still looking to extend the Grand Harbour facilities.

The most popular shore excursions are Valletta City tour, Malta's capital built by the



Knights of Malta and Jerusalem after the Great Siege of 1564 and a designated UNESCO World Heritage Site; Mdina, known as the Silent City and full of fantastic architecture; and The Crafts Village, where passengers can watch Maltese craftsmen creating their wares.

Malta is the location for the two day Seatrade Winter Cruising Forum taking place on January 17-18th, 2008.

Volos

New terminal development



A new terminal is under development at Port of Volos. A two-floor building with an area of 6,555sq mtr is planned. Port of Volos have already recently extended their central passenger piers.

Meteora, in northern central Greece, is one of the most remarkable places in the country and is accessible on a full day shore excursion from Port of Volos. Medieval monasteries hang precariously along the sides of giant rock formations – the name Meteora comes from the Greek word 'meteoros', meaning 'suspended in air'.

Another shore excursion is a visit to the town of Volos itself overlooked by Mount Pelion. Visit the Volos Archaeological Museum, which houses a collection of ancient treasures, or Makrinita village, located on the slopes of Mount Pelion. The narrow cobblestone streets are lined with small shops selling candied fruit, herbs, spices, and the like. The village square offers an astounding view of the surrounding countryside. In addition, one can visit Portoria, a resort village located high above sea level, offering stunning views of the Aegean below.



easyCruise

easyCruise and Lonely Planet team up for Greek survey

easyCruise and guidebook publisher Lonely Planet have conducted a survey to find out how well Greece is known in support of the cruise line's current deployment in Greek waters which runs through until March 2008.

The fun survey found that 34% of respondents did not know that the euro was the currency of Greece, with half of these claiming the drachma was still in use.



When it came to Greek mythology, the survey showed there was confusion in British minds.

Asked to name as many of the 12 deities as possible, over 45% of respondents could not name any, while others cited Roman gods in error such as Jupiter, Mars and Venus and still other respondents named Nero and Caesar.

Respondents fared much better on the geography question with 94% correctly naming the Aegean and Mediterranean seas as bordering Greece, although 2% claimed that the Black Sea washed around Greece.

easyCruise approached Lonely Planet to provide destination information for its website on the Greek Islands easyCruiseOne visits. Lonely Planet head of business development, Ushma Patel, commented: 'The information that we are providing will help people to plan what they do with their time on land and get the most from their trip. The survey highlights that many people know surprisingly little about Greece despite its popularity as a holiday destination.'



Costa Crociere

Costa's 1 millionth booking milestone



Costa Crociere set a new record in July by booking its 1 millionth passenger in a year – a milestone reached in an eight-month period. The company has set a new goal of 1.5m customers a year in 2010.

'Our 1 millionth customer is a historic achievement and one that fills us with pride,' said Costa chairman and ceo Pier Luigi Foschi, who thanked employees, customers and partners for their support.

Foschi added that Costa now aims to boost its annual customer numbers by 50%, to 1.5m, in three years.

In the past decade, Costa has more than tripled its customer count, from 350,000 in 1997 to 1m reservations recorded in the first eight months of 2007.

The growth is being spurred by the introduction of 11 ships in the 11-year period from 2000 to 2010, an investment of approximately €4.5bn.

Cunard

Queen Victoria coming to Med

Set to debut in December, Queen Victoria will spend the coming year charting a far-reaching course throughout Europe. The schedule includes varied open-jaw Mediterranean itineraries and numerous roundtrip voyages from Southampton.

The Europe deployment stretches as far south as the Egyptian city of Alexandria; as far east as Yalta, Ukraine, on the Black Sea;

and west to Las Palmas in the Canary Islands. There will be overnights in Venice and Istanbul.

Numerous 12-day voyages depart from Barcelona, Venice, Civitavecchia (Rome) and Piraeus (Athens). Roundtrips from Southampton include a 10-day cruise to the Canary Islands, a four-day jaunt to Western Europe and a 14-day cruise to varied destinations in Spain, France, Italy, Malta, Tunisia and Gibraltar.



MSC Cruises

MSC Cruises – nine ships in Med in 2008



MSC Cruises will feature 78 different itineraries to more than 120 ports in its 2008 Europe programme and all of the fleet's nine ships will be in the Mediterranean at some point in the year with two of the newest vessels operating year-round in the region.

In August, MSC Cruises held a double ceremony at Aker Yards France, floating out the 92,400gt MSC Poesia, third in the Musica class, and commencing steel-cutting on sister ship MSC Magnifica.

Guests were also able to witness progress on the MSC Fantasia, first of two new 133,000gt post-Panamax vessels under construction at the same yard.

MSC Cruises ceo Pierfrancesco Vago described MSC's current growth pattern as probably unprecedented within the cruise industry. The company's fleet will have increased from four ships of 3,962 lower berth capacity in 2003 to 12 vessels of 24,864 lower berths in 2010, he said.

Newbuilding sizes during this period have progressed by steady increments of about 40% or 900 passengers a time, from the Opera class to Musica class to Fantasia class, he added.

Bassani makes travel easier in Venice

MedCruise associate member, Bassani S.p.A., an Italian shipping agent and ground handler, has developed TravelClear, a new set of services offered to cruise line passengers disembarking in Venice that reduce the stress and discomfort associated with air travel.

TravelClear enables cruise passengers returning home via Venice Marco Polo International Airport to avoid queues at the check-in counters and at security control, and to gain access to the VIP lounge.

The service is available for passengers on flights operated by Lufthansa, Air France, KLM, Alitalia and Swiss. Each year Bassani handles around 100,000 passenger turnarounds in Venice mainly for Princess, Crystal, Silversea, Hapag and Sea Cloud.

TravelClear can also offer a pre-check-in to the final destination on board the ship the day prior to departure, with boarding cards delivered to guests in their staterooms. On arrival at the airport, luggage can be dropped off at a dedicated counter and travellers proceed directly through security control using the fast-track lanes.

The pre-check-in option is not available for passengers flying directly to the US or UK as the authorities will not allow it, says Filippo Olivetti, Managing Director of Bassani who developed TravelClear and serves as TravelClear president. Yet travellers on direct flights to the US or UK may purchase a TravelClear VIP Pass to transit through the priority security lane and enter the VIP lounge.

Passengers may only purchase the TravelClear service from the cruise operator, 'enabling lines an opportunity to increase on-board revenues and offer quality service to passengers even when they have left the ship,' remarks Olivetti.

Also, TravelClear now offers 'Luggage Valet', a service that forwards passenger luggage from the ship to a final home destination. Luggage Valet is designed for those travellers wanting to experience a journey without the challenges of carrying heavy luggage throughout their trip.

TravelClear offers this personalised door-to-door service for luggage delivery with a 24-hour notice on-board.



Filippo Olivetti - Managing Director of Bassani

Ports & Passenger Shipping course November 24-27th 2007

Professional development course for MedCruise members

MedCruise and the Escola Europea de Short Sea Shipping (2E3S) have formally agreed to collaborate in the creation of a professional development course, Ports and Passenger Shipping, the first to be offered to MedCruise member ports' staff. The course will take place from 24-27th November 2007, aboard a deluxe Grimaldi Line ferry travelling from Barcelona and calling at Genoa.

Laurent Monsaingeon, MedCruise president and director of French Riviera ports; José Torrado, MedCruise professional development director and president of the port of Ceuta; Jordi Valls, 2E3S and Barcelona port president, and Eduard Rodés, 2E3S Director, met at the Port of Barcelona in June to sign the collaboration agreement.

This agreement allows MedCruise, with its experience and involvement in the cruise industry, to join efforts with 2E3S, a European Commission-sponsored educational institution that provides port industry professionals with management training in commercial and passenger shipping in Europe and in the Med.

2E3S was founded in September 2006, by the Barcelona Port Authority in cooperation with the ports of Civitavecchia and Genoa, Grandi Navi Veloci, and the Grimaldi Naples group. 2E3S's main purpose is to develop academic courses and other activities related to short sea shipping to promote this modality of maritime transport.

MedCruise offers this course to its members' staff as part of its mission to encourage the application of best management practices at its member ports, to support the growth of the cruise industry in the Mediterranean and adjoining seas, and to promote the development and success of its cruise port members.

The three-day course will be taught by a team of cruise industry executives, government leaders and port executives.

The programme's coursework includes a wide range of subjects from the economics of the cruise line, diversifying shore excursions, port security and emergency management, cruise itinerary planning, passenger terminal design, managing port congestion, and tours of the state-of-the-art passenger terminal facilities in both Barcelona and Genoa.

The course will apply a 'hands-on', active learning methodology in which all students must participate to help solve industry-related problems through case study analysis and presentations.

MedCruise member port staff participating will obtain diplomas from 2E3S upon completion of the course.

It is hoped that sailing together from Barcelona to Genoa and working together in teams will allow port staff students and participating private- and public-sector industry leaders to develop good working relationships that will last even after the course is finished.



Collaboration signatories L-R: Torrado, Valls, Monsaingeon and Rodés

MedCruise Members

■ Alanya	■ Naples
■ Alicante	■ Palamos
■ Almeria	■ Palermo
■ Balearic Islands	■ Pescara
■ Barcelona	■ Piraeus
■ Bari	■ Portoferraio
■ Batumi	■ Portuguese ports
■ Cagliari	■ Ravenna
■ Cartagena	■ Rijeka
■ Castellon	■ Sete
■ Catania	■ Sevastopol
■ Ceuta	■ Sibenik
■ Cyprus ports	■ Sinop
■ Dubrovnik, Korcula	■ Sochi
■ Egyptian ports	■ Split
■ French Riviera ports	■ Tarragona
■ Gibraltar	■ Toulon, St Tropez
■ Koper	■ Trieste
■ La Spezia	■ Tunis
■ Lattakia	■ Valencia
■ Livorno	■ Valletta
■ Malaga	■ Venice
■ Messina	■ Volos
■ Monaco	■ Zadar
■ Moroccan ports	

Contacts

MedCruise

José Campos
Secretary General
Portal de la Pau, 6
08039 Barcelona, Spain
Tel: +34 607 87 87 50
Fax: +34 93 306 88 17
secretariat@medcruise.com
presidency@medcruise.com



MedCruise News

Editor: Mary Bond
Editorial Assistant: Libby Isted
Production Editor: Fiona Hockey
Seatrade Communications Ltd
Tel: +44 1206 545121
Fax: +44 1206 545190
mary@seatrade-global.com

Seatrade

Published by Seatrade Communications Ltd