

MEDCRUISE AWARDS 2021

GALATAPORT
İSTANBUL



Revival and Redefinition of Istanbul's Historic Port

A New Generation Art, Shopping, Gastronomy, Commerce and Tourism Destination

WORLD'S FIRST UNDERGROUND TERMINAL



Underground Cruise Terminal

The first underground cruise terminal of the world with the inspiration to open the 1.2 km coastal strip of the Bosphorus to public after 200 years



Special Hatch System Creating Temporary Customs Area

A groundbreaking innovation enabling locals and visitors of Karakoy and Istanbul to enjoy Galataport Istanbul while all logistic operations including ground transportation are handled under sea level



Sublime Interior Design

The historic architecture and character of the ancient cisterns of Istanbul was referenced in the interior shell built by Autoban architecture company within the terminal space, through rounding the edges of the columns and structural forms of the upper floors.



Next-Gen Shopping and Gastronomy

Open air and low-rise buildings, housing local and international brands including Turkey debut of local and international restaurants



Latest Masterpiece of Renzo Piano

Hosting the new museum building of Istanbul Modern, the first contemporary arts museum of Turkey, which is designed by world-renowned architect Renzo Piano



Prestigious Peninsula Hotels brand is in Istanbul for the first time

Peninsula Istanbul will welcome its guests within the renovated heritage buildings and a new ballroom with a special guillotine facade opening up in 15 seconds



Innovation Center & Flexible Work Spaces

An Innovation Center and flexible work spaces for inspirational collaboration with creative industries and start-ups

25m

yearly total visitors expected

7m tourists

1.5m cruise passengers and crew

72%

increase in arts & culture activities in the local community*

LOCAL COMMUNITY ENRICHMENT



Turkey's New Arts & Culture Hub

The first museum square of the city with Istanbul Modern and Istanbul Painting and Sculpture Museum, crowned by the historical Clock Tower



A Major Economical Contribution to the Neighborhood and the City

\$1.7 billion total project investment will regenerate and enhance the historical part of Turkey



GALATAPORT
İSTANBUL



Galataport Istanbul is a unique waterfront destination not only in Turkey but also in the rest of the world. There is no benchmark for this project even though similar investments exist all around the world.

Positioned as a 'home port', Galataport Istanbul is set to vitalize cruise tourism across a wide geography from the Mediterranean basin to the Black Sea. The project hosts the world's first underground cruise ship terminal with a special hatch system, connected to an underground terminal, both of which have already received great global praise.

Galataport Istanbul is set to become the top choice of fine living, an appealing destination where visitors and their children can spend their entire day in a delightful and safe environment. It is designed as an eco-system that will offer the essential digital features that make life easier at the heart of the city, alongside a full range of the latest technologies. Galataport Istanbul will create innovative experience areas combining shopping, dining and event experiences on physical and digital media.

Galataport Istanbul will feature an architectural design with large public squares and open spaces that will facilitate social distancing in line with the "new normal" brought about by the pandemic. This concept will offer visitors a breath of fresh air as they enjoy their time at the heart of the city.

Galataport Istanbul is projecting to welcome 25 million visitors, seven million tourists, including 1.5 million cruise passengers and crew per year.

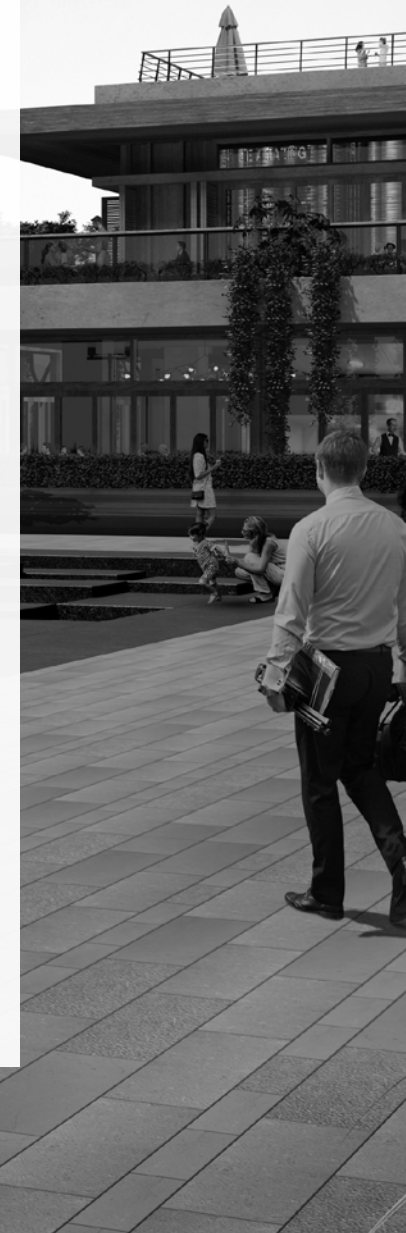

A black and white architectural rendering of the Istanbul Cruise Terminal entrance. The building features a large, arched concrete structure with a glass-enclosed entrance. The words "ISTANBUL CRUISE TERMINAL" are inscribed in large, spaced-out letters across the upper part of the arch. Several people are visible walking through the entrance and standing near the glass doors. The overall design is modern and minimalist.

World's First Underground Terminal

ISTANBUL CRUISE TERMINAL

World's First Underground Terminal with a Special Hatch System

Galataport Istanbul has been built at the heart of the city and brings many firsts, such as the world's first underground cruise ship terminal with a special hatch system, connected to a 29,000-square meter underground terminal, both of which have already received great global praise.

The main inspiration behind building the cruise terminal underground is the desire to open the 1.2 km coastal strip of Bosphorus to public as a 24/7 outdoor art and leisure space. This strip has been closed off for the past 200 years.

By resurrecting the historical spirit of maritime commerce, this hub will put Galataport Istanbul, the new destination of Istanbul for Karakoy which will be an inspiration for all of Istanbul. This groundbreaking innovation will enable all guests of Karakoy and Istanbul enjoy Galataport Istanbul while the cruise logistic operations including ground transportation are handled under sea level.



View of the promenade without cruise ship



GALATAPORT
ISTANBUL

View of the promenade with one ship



View of the promenade with multiple ships



Sublime Interior Design

Undertaking the interior architecture of the terminal, Autoban architecture company has designed a spacious, bright and relaxing space inside the terminal where the passengers will not feel that they are underground. In particular, the use of intense and variety of light effects on both ceilings and walls make a significant contribution to the realization of this goal. There are 14 ancient water cisterns in Istanbul dating back from the Byzantine period and used in the Ottoman period.

The terminal is also inspired by the design of the cisterns and features a Galataport Istanbul-specific arch motif.

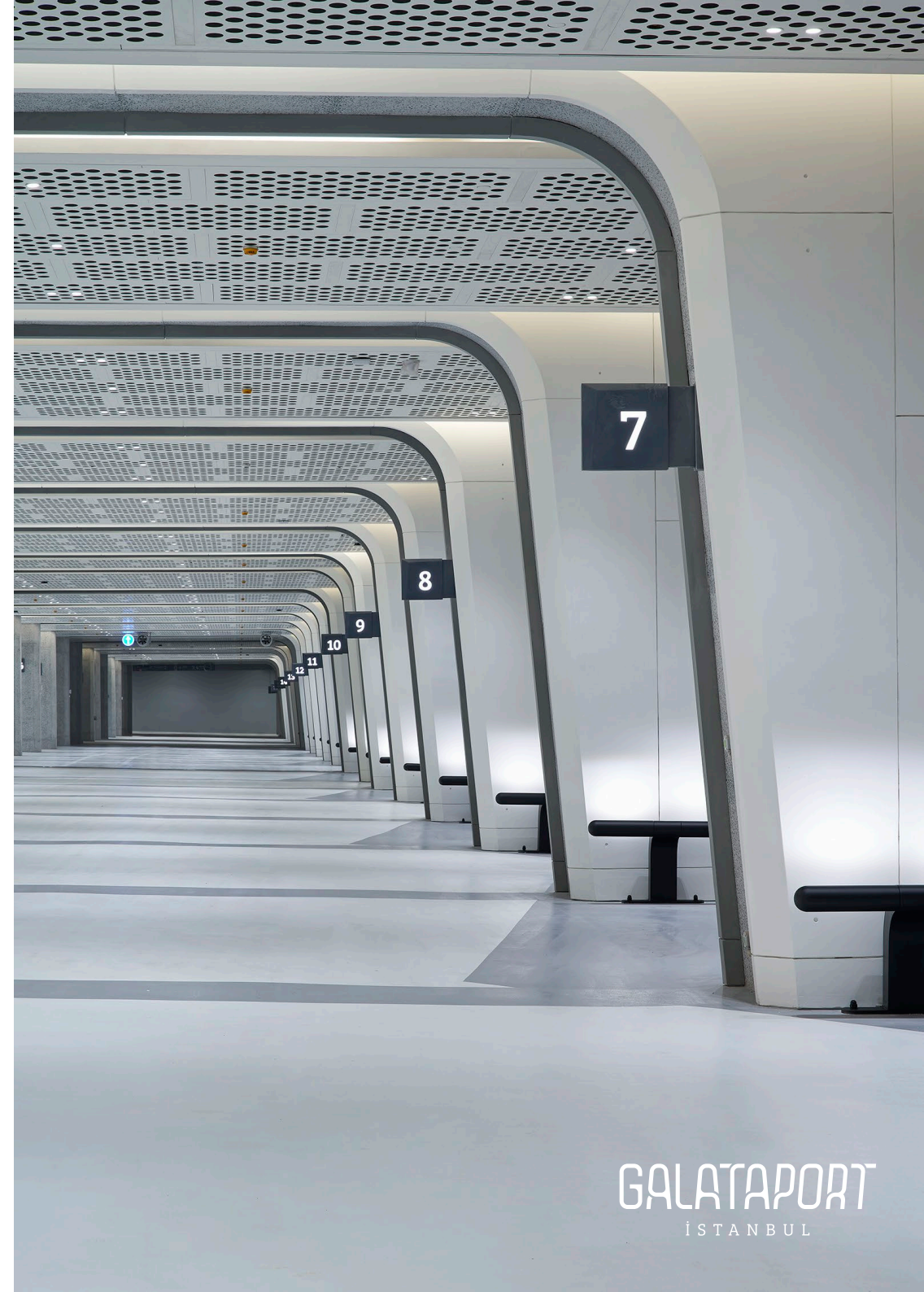







Welcome, User
User

- Homepage
- Reports
- Layout Plan
- Reservations ▾
- Placement ▾
- Cruise Ships
- Rates ▾
- Travel Agencies
- Users
- Settings ▾



Cruise Ship
88



Travel Agency
5



Reservation
Request
131



Reservation
56

Berthlog Management System

Berthlog, the cruise terminal management system developed by Doğuş Technology for Galataport Istanbul, has been designed to boost the operational efficiency of the cruise terminal and to drive growth in the industry.

The Berthlog technology is capable of providing services to more than 50 cruise companies and 20 port agencies.

An architectural rendering of a modern, multi-story building at night. The building features a prominent rooftop garden with various plants and trees. The ground floor has large glass windows and doors, and the upper floors have balconies with railings. The building is illuminated from within, and the rooftop garden is lit up. In the foreground, there is a public plaza with a paved area and some low walls. Several people are walking and sitting on the plaza. The overall atmosphere is modern and urban.

Environmental Responsibility Award



Galataport Istanbul has become the first cruise port in Turkey that entails the use of oil boom service from ships fueling at sea.



Salıpazarı Section Post Office Building

American Green Building
Certificate **LEED Gold** target

The Peninsula Istanbul

British Green Building Certificate
BREEAM Excellent target



Encourage the use of public transportation by the public and employees given the proximity of public transportation facilities and accessibility.



Encourage use of bicycle by creating parking areas.



Encourage the use of electrical low emission, fuel efficient vehicles by creating priority parking spaces and charging stations.

SP Parking Units

120

PP Parking Units

50

KK Parking Units

60

97

12

30



These actions
target to reduce
the private
vehicles' carbon
emissions.



Compared to the equivalent base building defined in the ASHRAE 90.1-2007 standards, Galataport Istanbul is providing energy efficiency by reducing consumption:

Salıpazarı & Post
Office Building:
Minimum - %34

The Peninsula
Istanbul:
Minimum - %48



Providing the coolant required for heating and cooling devices from sea water increases energy efficiency as well as minimizing the use of refrigerant gas that causes ozone depletion, minimizing the impact on global warming.



Compared to the building with average water needs defined by EPA standard:

Salıpazarı, Paket Postanesi and
The Peninsula Istanbul:
Minimum - %45

Compared to landscape design with average water needs defined by EPA standards; Galataport Istanbul is providing water efficiency by reducing consumption proportionally:

Salıpazarı, Paket Postanesi and
The Peninsula Istanbul:
Minimum - %50



Gray water recovery is implemented at The Peninsula Istanbul building, and condenser water recovery is implemented in Salıpazarı and Post Office buildings.



Compared to the pre-privatization era, the landscape areas and green roofs have been increased to reduce the heat island effect and improve the buildings' energy efficiency



GALATAPORT

İSTANBUL